



P: 866.733.0233
www.solerpalaucanada.com



Except CM 10



- NOTES:**
 1. Outlet flange is optional for all sizes.
 2. Unit rotatable to all positions: 45°, 90°, 270°, 315°, & 360°. "CW" rotation is shown: "CCW" rotation is similar but opposite.

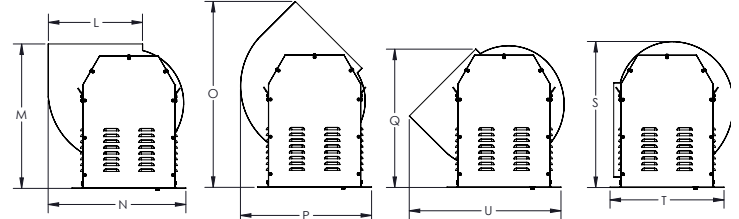
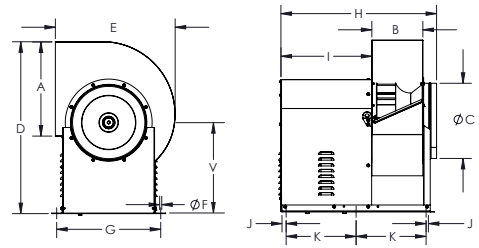

Model	A	B	C	D	E	F	G	H	I	J	K
10	12-5/8	7-1/16	9-13/16	23-7/8	17-3/16	1/2	16-7/8	25-3/8	15-1/2	1	10-13/16
12	15-7/8	8-3/4	12-3/8	29-3/16	21-3/8	1/2	19-5/8	28-11/16	17-1/16	1	12-1/2
14	17-7/8	9-3/4	14	32-3/4	22-3/4	1/2	19-5/8	30-3/4	17-13/16	1	13-5/16
16	19-15/16	10-13/16	15-3/4	36-3/4	25-1/4	1/2	21-7/8	31-9/16	17-15/16	1	13-7/8
18	22-3/8	12-1/8	17-11/16	40-7/8	28-7/16	1/2	24-3/4	36-15/16	21-9/16	1	16-5/8
20	25-1/8	13-9/16	19-11/16	44-7/8	31-5/16	1/2	27-7/16	38-7/16	21-9/16	1	17-7/16
22	28-1/8	15-3/16	22-1/16	49-3/8	34-15/16	1/2	29-7/8	40-1/8	21-5/8	1	18-1/4
24	31-1/2	17-1/16	24-13/16	57-1/8	39-1/8	1/2	33-1/4	41-15/16	21-5/8	1	19-1/8
27	35-3/8	18-7/8	27-15/16	59	44	1/2	35-1/8	50-1/8	27-1/8	4	19-13/16
30	39-5/8	21	31-1/2	64	49-1/4	1/2	39-7/16	53-13/16	28-11/16	2	23-5/8
36	44-1/2	23-7/16	35-7/16	71-7/8	55-1/4	1/2	44-5/8	54-15/16	27-5/16	2	24-3/16

Model	L	M	N	O	P	Q	S	T	U	V
10	12-3/4	21-5/8	20	25-7/8	19-3/8	21-5/8	20-3/8	18-7/8	22-7/8	13-1/4
12	16	26	24-1/4	32-1/2	23-1/8	24-3/4	24-7/8	21-7/8	27-1/2	15-3/4
14	18	28	25-7/8	35-5/8	24-5/8	27	28-1/4	23-1/4	29-3/8	17-11/16
16	20	31-1/8	29-1/4	39-7/8	27-5/8	29-7/8	31-3/8	26	32-1/4	19-11/16
18	22-1/2	34-3/8	32-3/4	44-1/8	38-1/4	33-3/4	34-3/4	29-1/4	36-7/8	21-5/8
20	25-1/4	37-1/2	36-1/8	48-3/8	34-1/4	37-1/8	38-1/8	32-3/8	40-1/2	23-5/8
22	28-1/4	41	40-1/8	53-1/4	37-3/4	40-3/4	42	35-3/4	45-3/8	25-9/16
24	31-5/8	45-7/8	44-5/8	59-3/4	42-1/8	45-1/2	47	39-7/8	50-3/4	30-1/4
27	35-1/2	55-5/8	50-5/8	71-1/2	46-1/8	54-7/8	57-1/4	44	57-1/2	28-3/4
30	39-3/4	62-3/8	57-1/8	80-1/8	51-1/4	62-1/2	63-1/4	49-1/4	61-1/4	30
36	44-3/4	70-1/2	64-3/8	89-3/4	57-1/2	70-5/8	70-5/8	55-1/4	72-3/8	33-1/2

FAN SPECIFICATIONS									MOTOR SPECIFICATIONS				
Line	Qty.	Model No.	Tag	CFM	SP	Fan RPM	BHP	Sones	HP	Volts	Phase	Hertz	Encl
1													
2													
3													
4													

ACCESSORY ITEMS					ACCESSORY ITEMS						
	1	2	3	4	5		1	2	3	4	5
<input type="checkbox"/>						<input type="checkbox"/>					
<input type="checkbox"/>						<input type="checkbox"/>					
<input type="checkbox"/>						<input type="checkbox"/>					
<input type="checkbox"/>						<input type="checkbox"/>					

Subject to change unless approved in submittal by S&P
CM_Submittal_SPCanada

